

INSTALLATION
INSTRUCTIONS

Product Code: SE21000

IMPORTANT: Please read these instructions before commencing installation and retain for future reference.

Components

Tools Required

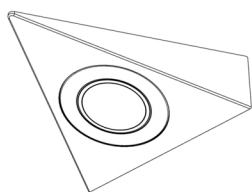

1 x SE21000 TrioTone™ Bermuda LED Triangle Light

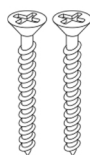

2 x Screws

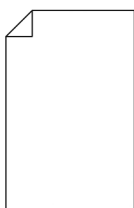

1 x Instructions Manual



Pencil



Screwdriver



Ø10 mm Drill Bit



Power Drill

Important Safety Information

Please read these instructions carefully before attempting to install this product. It is advisable to keep these instructions in a safe place for future reference.

We recommend that you consult a qualified electrician. All electrical installation must be carried out in accordance with current IEE wiring regulations (BS7671).

These products must not be modified, if any modifications are made, it may invalidate the warranty and may render the product unsafe. These LED lights operate low voltage (24V).

Do not wire the individual LED light fittings directly to the mains. This product is for indoor use only. Keep out of moisture and use only in dry rooms.

- If in doubt, installation must be carried out by a qualified electrician.
- Install on smooth flat surface(s) only.
- Do not exceed or stretch the cable length of each LED wire.
- This product is IP20 Rated.
- The wattage for each light is 2W.

Safety Instructions

1. Before commencing installation or maintenance, isolate the main electrical supply for the appropriate circuit at the fuse board.
2. This product is only suitable for connecting to a 240V 50Hz supply with a 24V Sensio Driver.
3. Never exceed the total output of the LED Driver.
4. The lights should be mounted onto a secure surface.
5. Suitable for furniture lighting.
6. When the lamp expires the fitting must be replaced
7. Class III safety extra low voltage (SELV).

Waste Electrical & Electronic Equipment (WEEE)

The symbol on the product, or on the document accompanying the product, the crossed out wheellie bin symbol, indicates that this product may not be treated as household waste. Instead it shall be handed over to the applicable collection point for the recycling of electrical and electronic waste.



Sensio House, Unit 7, Speedwell Road, Whitwood, Castleford, West Yorkshire, WF10 5PY

www.sensio.co.uk

Technical drawings for illustration purposes only, Sensio has the right to change any information without prior notice.

Installation

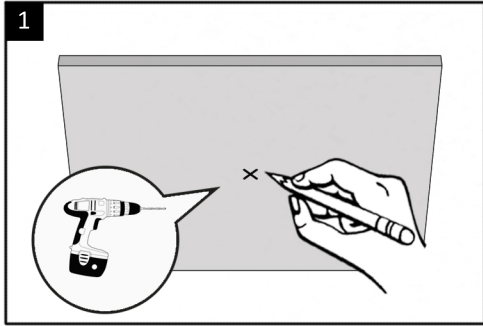

Carefully mark the desired location for the light and then proceed to drill a $\varnothing 10\text{mm}$ hole.

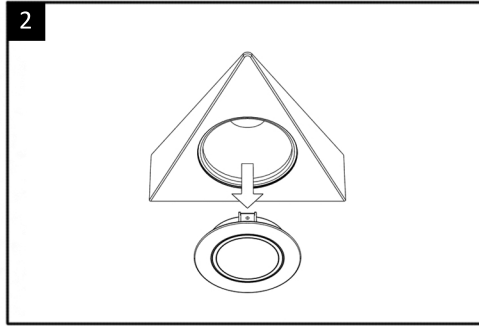

Remove the lamp from the frame.

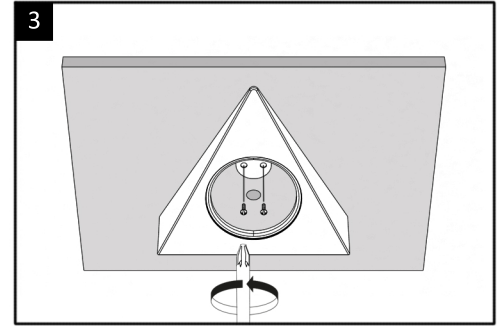

Fix the frame in place with the two screws provided.

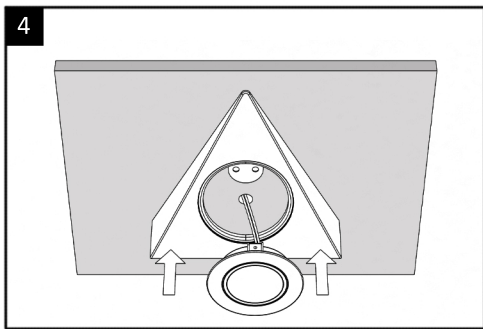

Thread the cable through the pre-drilled hole and press the lamp into the frame.

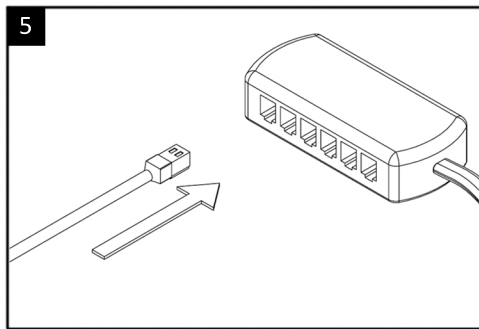

Connect the light to the LED Driver by inserting the JB4 connector into the distribution block.

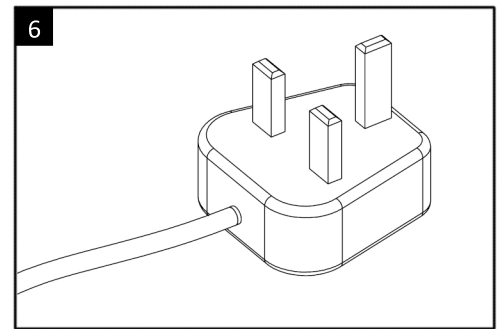

Finally, connect the driver to the mains supply, or attach a plug.

TrioTone™

Quick Connect

Colour Temperatures:
Warm White (3000K)
Natural White (4000K)
Cool White (5000K)

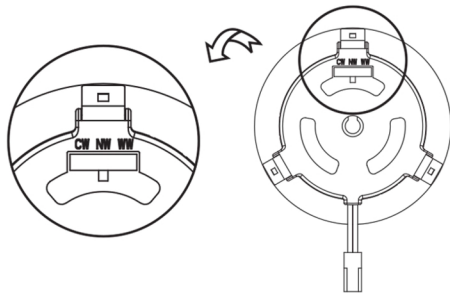

This LED lamp has TrioTone™ technology, which enables the colour temperature to be changed between three different settings. This can be achieved by flicking the switch located on the underside of the lamp.

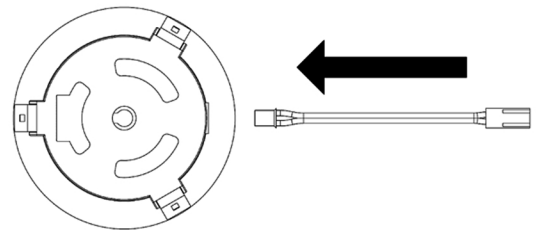

To make installation and maintenance as easy as possible, this product has a quick-connect port that enables the driver connection cable to plug directly into the back of the lamp.

Maintenance & Care

- Ensure that the power is disconnected prior to cleaning.
- To keep the finish of this product, wipe over with soft cloth periodically.
- Do not use harsh chemical solvents, this may dis-colour or damage the finish.